

spinlock

# LUME-ON™

LIFEJACKET ILLUMINATION



- \\ Lume-On™ lifejacket illumination lights are water activated.
- \\ LED lights use the lifejacket bladder as a diffuser to increase visibility.
- \\ The 2 lights bond directly onto the underside of the inflatable part of your lifejacket.
- \\ The Lume-On™ can only be attached to lifejackets with a separate inflatable and cover construction.
- \\ Lifejacket must be thoroughly dry before attaching the Lume-On™ or the stickers will not bond.
- \\ Battery life - minimum 2 hours flashing at full intensity.

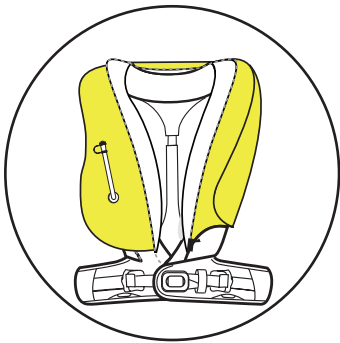

1. Unpack your lifejacket following manufacturer's instructions.

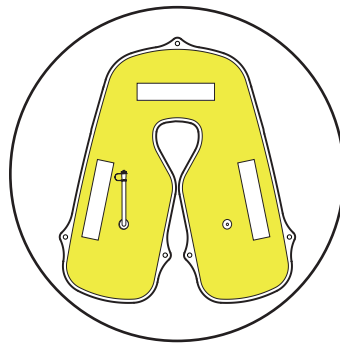

2. Lay the inflatable bladder on a table, as flat as possible.

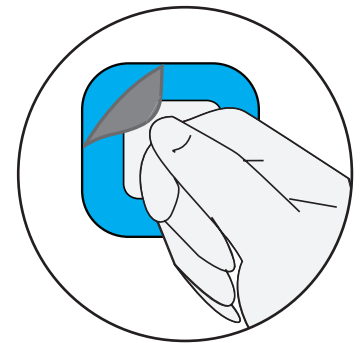

3. Peel the sticker from a Lume-On™.



4. Turn the bladder over, you do NOT need to remove the bladder from lifejacket.

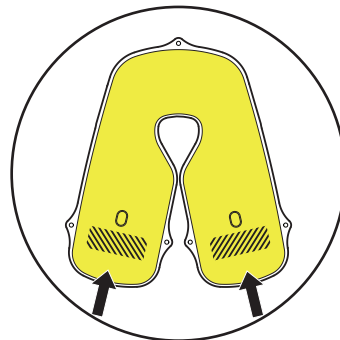

5. Stick each Lume-On™ to the bottom of the back of the bladder lobe, in the area pictured. Press firmly.

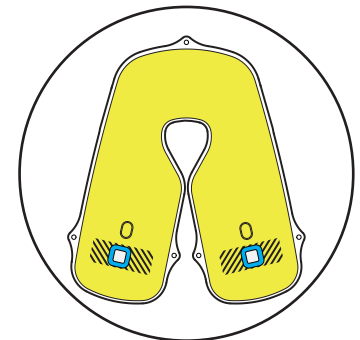

6. Ensure the positioning will not affect the packing of your bladder. Repeat process for the other side.

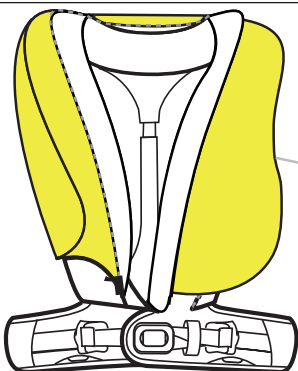

6. If possible, leave lifejacket flat and unpacked for 24hrs to ensure full bonding of the stickers.

Repack the lifejacket following manufacturer's instructions.

Lume-On™ positioning on other lifejacket brands may vary. For best results inflate the lifejacket using the oral tube and position at the bottom of each chamber where the lobe would be in the water. See the video for more information.