

DEFLECTION ANGLE

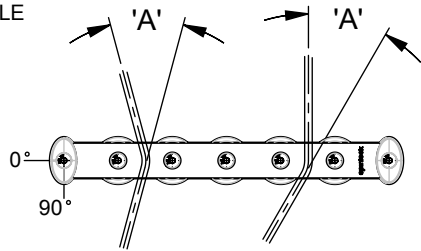

BISECTED ROPE ENTRY

STRAIGHT ROPE ENTRY

| DEFLECTION ANGLE, 'A' (°) | MAX ROPE TENSION (KG) |
|---------------------------|-----------------------|
| 10                        | 3440                  |
| 15                        | 2300                  |
| 30                        | 1160                  |
| 45                        | 780                   |
| 60                        | 600                   |
| 90                        | 420                   |

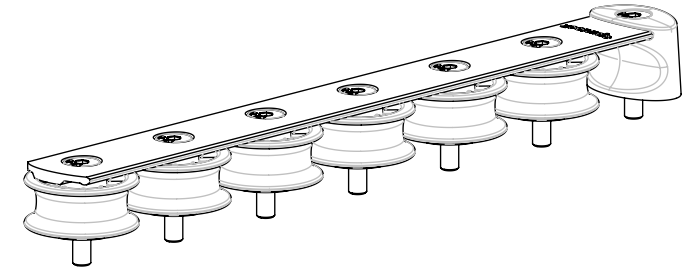

Ø 38 COMPOSITE SHEAVE (T38/6Y)  
ALLOY SHEAVE (T38/6YA)

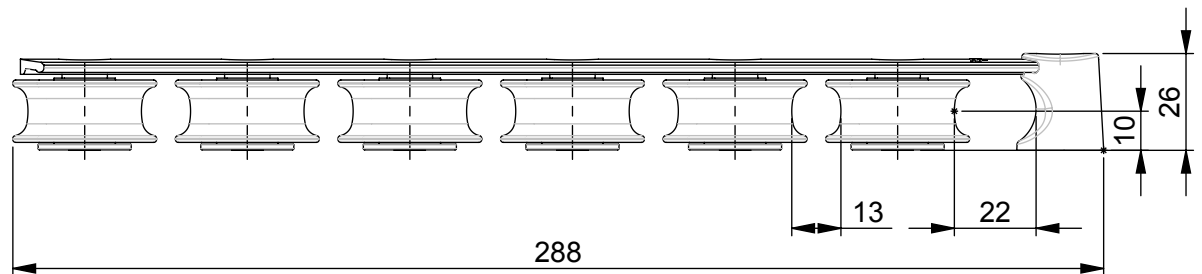
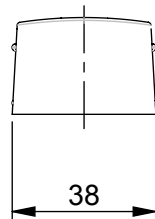
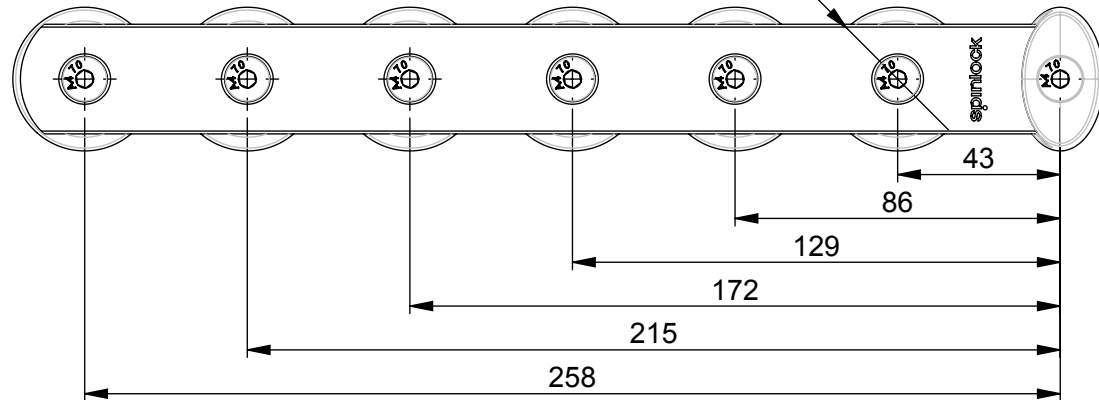

**spinlock**  
BE ADVENTURE-PROOF



**WARNING:**  
IF USING AS DRILL TEMPLATE, ENSURE PRINTER SETTINGS ARE ADJUSTED TO ACCOUNT FOR THE DRAWING SCALE AND **ALWAYS** CHECK DIMENSIONS BEFORE DRILLING.



**COPYRIGHT:**  
THIS DRAWING IS PROTECTED BY COPYRIGHT. ANY USE IS FORBIDDEN WITHOUT THE WRITTEN CONSENT OF SPINLOCK.

ALL DIMENSIONS IN MM

SCALE PAGE SIZE DATE

1:2

A4

MAR 2018

LINE SIZE:  
6-12mm  
FASTENERS  
M6 CSK  
x 7

PRODUCT CODE

T38/6Y

T38/6YA

WEIGHT

243g

359g

MAX LOAD

600kg

600kg

MAX LOAD PER UNIT

1800kg

1800kg

**T38/6Y**

FOR ANY MORE INFO CONTACT  
SPT@SPINLOCK.CO.UK